



**County of Montmorency**  
P. O. Box 789 – Atlanta, Michigan 49709  
Soil Erosion Officer  
Joseph Stone  
(989) 785-8006

**The Soil Erosion And Sedimentation Control Permit  
Application Must Be Completed In It's Entirety.  
There Are No Exceptions Incomplete Applications Will Be  
Returned For Completion.**

1. The applicant must complete all sections of this application. If you are not the owner and are applying as the designated agent for the landowner you must have a written statement from the landowner authorizing you to secure a permit in the landowner's name.
2. Location area of form (be as complete as possible).
3. Proposed Earth Change: Explain in detail what you intend to do, include size of earth change and name of nearest lake, stream, drain, or wetland.
4. Soil Erosion And Sedimentation Control Plan: Commercial projects provide two (2) sets of prints. One to be signed by Soil Erosion Officer and kept at job site and one for file. Non commercial projects may also require prints but that requirement is at the discretion of the Soil Erosion Officer. Non commercial projects include a completed site plan. Sample and site plan are attached. It must be completely filled out.
5. Parties Responsible For Earth Change: If designated agent fills out application they must include the person responsible for the earth change and who is to be contacted in the event that control measures are not working.
6. Performance Deposit: May be required and is at the discretion of the Soil Erosion Officer.

Sign the form.. Permit Fee **\$100.00**

Make Checks payable to: Montmorency County

**GENERAL CONDITIONS**

In accordance with Rule 1709 promulgated under the authority of Part 91, Soil Erosion and Sedimentation Control, of the Natural Resources and Environmental Protection Act, 1994 PA 451, as amended, and in addition to the information on the attached plan(s) and special conditions, the following general conditions apply to the earth change authorized by this permit:

- Design, construct, and complete the earth change in a manner that limits the exposed area of disturbed land for the shortest period of time.
- Remove sediment caused by accelerated soil erosion from runoff water before it leaves the site of the earth change.
- Temporary or permanent control measures shall be designed and installed to convey water around, through, or from the earth change at a non-erosive velocity.
- Install temporary soil erosion and sedimentation control measures before or upon commencement of the earth change activity and maintain the measures on a daily basis. Remove temporary soil erosion and sedimentation control measures after permanent soil erosion measures are in place and the area is stabilized. ("Stabilized" means the establishment of vegetation or the proper placement, grading, or covering of soil to ensure its resistance to soil erosion, sliding, or other earth movement.)
- Complete permanent soil erosion control measures for the earth change within five calendar days after final grading or upon completion of the final earth change. If it is not possible to permanently stabilize the earth change, then maintain temporary soil erosion and sedimentation control measures until permanent soil erosion control measures are in place and the area is stabilized.

**SPECIFIC CONDITIONS**

---

---

---

---

---

---

---

---

---

---

---

---

**PERMIT APPLICATION  
for Part 91  
SOIL EROSION AND  
SEDIMENTATION CONTROL**

**OFFICE USE ONLY**

|                 |
|-----------------|
| Permit Number   |
| Date Issued     |
| Expiration Date |
| File Number     |

**1. APPLICANT (Please check if applicant is the landowner or designated agent\*)**

|         |           |                  |                            |
|---------|-----------|------------------|----------------------------|
| Name    | Landowner | Designated Agent |                            |
| Address |           |                  |                            |
| City    | State     | Zip Code         | Area Code/Telephone Number |

**2. LOCATION**

|             |         |               |                |              |        |
|-------------|---------|---------------|----------------|--------------|--------|
| Section     | Town    | Range         | Township       | City/Village | County |
| Subdivision | Lot No. | Tax ID Number | Street Address |              |        |

**3. PROPOSED EARTH CHANGE**

|  |             |                       |   |
|--|-------------|-----------------------|---|
| Project Type:  | Residential | Multi-family          | Commercial                                  |
|  | Industrial  | Land Balancing        |   |
| Describe Project                                       |             |                       | Size of Earth Change (acres or square feet) |
| Name of and Distance to Nearest Lake, Stream, or Drain |             | Date Project to Start | Date Project to be Completed                |

**4. SOIL EROSION AND SEDIMENTATION CONTROL PLAN (Refer to Rule 323.1703)**

|   |   |
|---|---|
| <b>Note: ___ complete sets of plans must be attached.</b> | Estimated Cost of Erosion and Sediment Control                  |
|   | Plan Preparer's Name and Telephone Number      Area Code (    ) |

**5. PARTIES RESPONSIBLE FOR EARTH CHANGE**

|   |         |              |                            |                            |
|---|---------|--------------|----------------------------|----------------------------|
| Name of Landowner (if not provided in Box No. 1 above)    | Address |              |                            |                            |
| City  | State   | Zip          | Area Code/Telephone Number |                            |
| Name of Individual "On Site" Responsible for Earth Change |         | Company Name |                            |                            |
| Address   | City    | State        | Zip Code                   | Area Code/Telephone Number |

**6. PERFORMANCE DEPOSIT (If required by the permitting agency)**

|                          |      |                 |                              |                         |
|--------------------------|------|-----------------|------------------------------|-------------------------|
| Amount Required \$ _____ | Cash | Certified Check | Irrevocable Letter of Credit | Surety Bond             |
| Name of Surety Company   |      |                 |                              |                         |
| Address                  | City | State           | Zip Code                     | Area Code/Telephone No. |

I (we) affirm that the above information is accurate and that I (we) will conduct the above described earth change in accordance with Part 91, Soil Erosion and Sedimentation Control, of the Natural Resources and Environmental Protection Act, 1994 PA 451, as amended, applicable local ordinances, and the documents accompanying this application.

|                               |            |      |
|-------------------------------|------------|------|
| Landowner's Signature         | Print Name | Date |
| Designated Agent's Signature* | Print Name | Date |

\* Designated agent must have a written statement from landowner authorizing him/her to secure a permit in the landowner's name



**PLEASE COMPLETE**  
**ZONING AND HEALTH PERMIT PLANS ARE NOT ACCEPTABLE**

**SITE PLAN**

**Show on your site plan:**

- |                                  |  |
|----------------------------------|--|
| a) Arrow indicating north        | b) Stockpile locations                   |
| b) Scaled map                    | D) Timing and sequence                   |
| c) Driveway and parking areas    | j) Temporary SESC measures               |
| d) Well, septic, etc.            | k) Distance from lot lines               |
| e) Limits of earth change        | l) Distance from water or wetland        |
| f) Slope locations and steepness | m) Permanent SESC measures               |
| g) Soils information's           | n) Maintenance program for SESC measures |

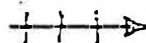
**NOTE:** Outline the entire proposed earth change area using a dashed line (-----)  
Any disturbance exceeding area indicated on plan will be considered a violation of the permit.

- LEGEND:**
- |                                    |  |
|------------------------------------|--|
| Indicates Direction Of drainage    |  |
| Indicates Location of Earth Change |  |
| Site Fence Where Required          |  |

Waters edge (lake, stream or wetland)

Applicant must contact the Soil erosion office if any changes or alterations are necessary on the site plan submitted on this application. If an extension becomes necessary applicant must contact this office for approval.

SOILS TYPE: SANDY LOAM

SYMBOLS LEGEND:

←+++++ INDICATES DIRECTION OF SLOPE



INDICATES AREA OF EARTH CHANGE

—X—X—X— INDICATES SILT FENCE LOCATION

CROSS SECTIONS:

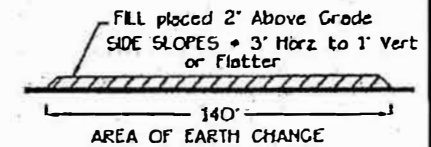
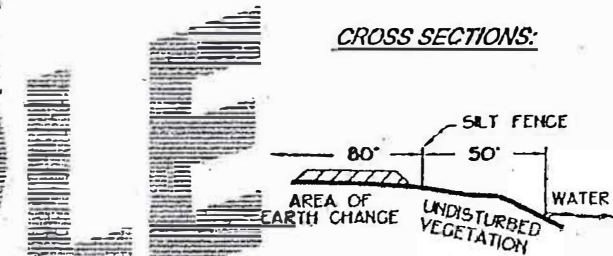

CONSTRUCTION SCHEDULE:

6/15/05  
INSTALL PERIMETER SEDIMENT CONTROLS

6/17/05  
GRADE SITE

6/17/05 - 9/10/05  
CONSTRUCTION OF BUILDING

9/15/05  
PAVING

9/15/05 - 9/20/05  
FINAL GRADE, SEED + MULCH

-REMOVE TEMPORARY PERIMETER CONTROLS  
WHEN VEGETATION IS ESTABLISHED.

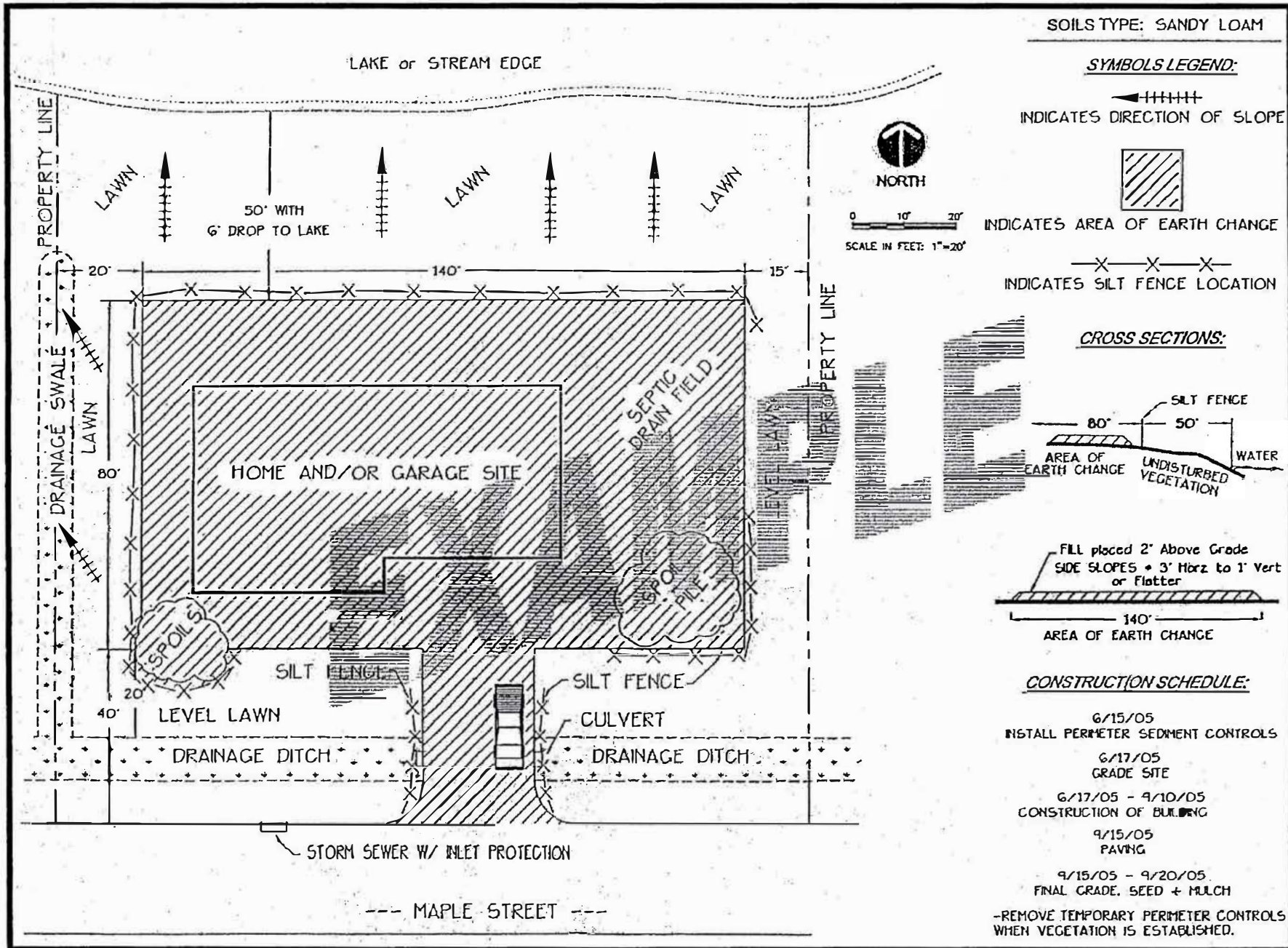

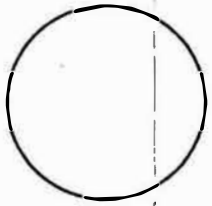

Place North  
Arrow  
In Circle

Lot Line length: \_\_\_\_\_ ft.



Lot Line length: \_\_\_\_\_ ft.

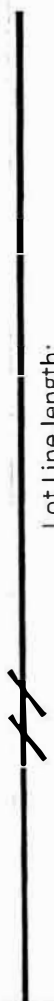

Owner is responsible for maintaining all permanent stabilization. Yes  No

If no, who is responsible for maintaining all permanent stabilization? \_\_\_\_\_

Seed all disturbed areas with a perennial seed mulch, per manufacturer's specifications, until stable. Owner to maintain stabilization.

Install all temporary SESC measures according to manufacturer's specifications.

|  |   |                                    |                  |                                    |           |
|--|---|------------------------------------|------------------|------------------------------------|-----------|
| Include the following on your site plan:                     |   | <input type="checkbox"/> Soil Type |                  | Estimated cost of erosion control: |           |
| <input type="checkbox"/> Buildings Existing/Proposed         | <input type="checkbox"/> Distance from Water              | Project Description:               |                  | Location address:                  | Date:     |
| <input type="checkbox"/> Driveway Existing/Proposed          | <input type="checkbox"/> Well/Septic                      |                                    |                  |                                    |           |
| <input type="checkbox"/> Permanent/Temporary Erosion Control | <input type="checkbox"/> Distance from adjacent lot lines | Preparer's Name:                   |                  | Preparer's Phone Number            |           |
| <input type="checkbox"/> Stockpile Locations                 | <input type="checkbox"/> Slope information                | County:                            | Water body name: | Township:                          | Tax ID #: |
| <input type="checkbox"/> Outline Proposed earth change       | <input type="checkbox"/> Direction of water flow          |                                    |                  |                                    |           |

County of Montmorency  
Department of Soil Erosion and Sedimentation Control  
12265 M-32 P.O.Box 789  
Atlanta, MI 49709  
Phone 989-785-8006 Fax 989-785-8007

Date: \_\_\_\_\_

Montmorency County  
Soil Erosion and Sedimentation Control  
12265 M-32 P.O.Box 789  
Atlanta, MI 49709

To Whom It May Concern:

I hereby authorize (Applicants Name) \_\_\_\_\_ to apply  
For and sign (as Agent) the necessary Montmorency County Permit Applications for project \_\_\_\_\_  
\_\_\_\_\_. Any questions should be directed to  
(Contractor) \_\_\_\_\_.

Sincerely,

---

Property Owner

Date

| APPROXIMATE PROJECT TIMING |      |   |
|----------------------------|------|---|
| Month                      | Year | For MINOR PROJECTS  |
|                            |      | Temporary Erosion Control Measures Installed (install all SESC measures according to manufacturer's specifications)           |
|                            |      | Gravel Drive/Entrance Installed   |
|                            |      | Land Cleared or Excavation Started  |
|                            |      | Final Grading/Seeding (seed all disturbed areas with a perenial seed & mulch per manufacturere's specifications until stable) |
|                            |      | Permanent Erosion Control Measures in Place   |
|                            |      | Temporary Erosion Control Measures Removed Once Site Is Stabilized  |

| Month | Year | For MAJOR PROJECTS  |
|-------|------|---|
|       |      | Temporary Erosion Control Measures Installed (install all SESC measures according to manufacturer's specifications)           |
|       |      | Gravel Drive/Entrance Installed   |
|       |      | Land Cleared or Excavation Started  |
|       |      | Detention/Retention/Sediment Ponds Installed  |
|       |      | Road Constructed  |
|       |      | Utilities Installed   |
|       |      | Final Grading/Seeding (seed all disturbed areas with a perenial seed & mulch per manufacturere's specifications until stable) |
|       |      | Catch Basins/Ponds Cleaned  |
|       |      | Permanent Erosion Control Measures in Place   |
|       |      | Temporary Erosion Control Measures Removed  |

|  |                          |  |
|--|--------------------------|--|
| Yes  | No                       |  |
| <input type="checkbox"/>   | <input type="checkbox"/> | Owner is responsible for maintaining all permanent stabilization |
| If no, who is responsible for maintaining all permanent stabilization? |                          |  |





### Part 91, Soil Erosion and Sedimentation Control Plan

Minimum Requirements

Project: \_\_\_\_\_

| Rule 1703 Requirement   | Included in Plan?   | Comments |
|---|---|----------|
| Map with scale: 1" = 200' or less, or indication of exact distances between noted features on site plan, including site location sketch | Yes <input type="checkbox"/> No <input type="checkbox"/>            |          |
| Legal description of property (town, range, section, quarter-quarter section)   | Yes <input type="checkbox"/> No <input type="checkbox"/>            |          |
| Proximity of any proposed earth change to lakes and/or streams  | Yes <input type="checkbox"/> No <input type="checkbox"/>            |          |
| Predominant land features   | Yes <input type="checkbox"/> No <input type="checkbox"/>            |          |
| Slope description or contour intervals  | Yes <input type="checkbox"/> No <input type="checkbox"/>            |          |
| Soils survey or written description of the soil types of the proposed exposed land area   | Yes <input type="checkbox"/> No <input type="checkbox"/>            |          |
| Description and location of the physical limits of each proposed earth change   | Yes <input type="checkbox"/> No <input type="checkbox"/>            |          |
| Description and location of all existing and proposed on-site drainage and dewatering facilities  | Yes <input type="checkbox"/> No <input type="checkbox"/>            |          |
| Timing and sequence of each proposed earth change   | Yes <input type="checkbox"/> No <input type="checkbox"/>            |          |
| Location and description for installing and removing all temporary SESC measures  | Yes <input checked="" type="checkbox"/> No <input type="checkbox"/> |          |
| Description and location of all proposed permanent SESC measures  | Yes <input type="checkbox"/> No <input type="checkbox"/>            |          |
| Maintenance program for all permanent SESC measures and designation of person responsible for maintenance                               | Yes <input type="checkbox"/> No <input type="checkbox"/>            |          |

**\*If No is checked above, the plan must be revised to include the missing element prior to submittal/approval.**

**Other Comments:**